



LUXE

THE BASICS



Oi! THIS IS A PRECISION INSTRUMENT

Treat with the same care that you would your bike's other parts: your spokes, your derailleurs, your rear lights, your rear.

If you're in doubt about how to mount, use, or troubleshoot the Oi, visit the Knog website or, of course, your local bike shop.

Oi! GET IT ON

- ① TAKE OUT THE Oi LUXE & REMOVE THE HEX BOLT using the hex key provided.



- ② If you have the **Large Oi** but a **23.8, 25.4, or 26mm diameter bar** you'll need to put the **appropriate spacer on your bar** to make Oi sit flush. Make sure gap faces straight up. If your bar is 23.8mm, place the rubber tape provided inside the larger spacer.

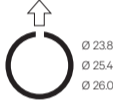

- ③ POSITION ON A CYLINDRICAL PART OF THE HANDLEBAR THAT YOU FIND COMFORTABLE, BUT IS NOT CURVED OR TAPERED.



Oi! GET IT ON

- ④ ASSEMBLE BELL ON HANDLEBAR UPSIDE DOWN. INSERT SCREW, BUT DO NOT TIGHTEN.

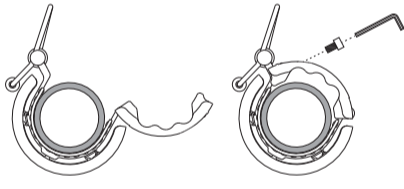

- ⑤ ROTATE BELL UNTIL BOTTOM OF HAMMER IS HORIZONTALLY ALIGNED WITH CENTER OF HANDLEBAR. TIGHTEN SCREW.

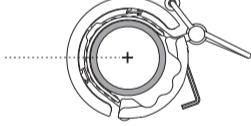

Please note: this may not suit every cable configuration

Oi! DON'T FORGET

SIZE MATTERS:



SHAPE MATTERS:



CYLINDRICAL BAR



NOT SUITABLE FOR AERO

For more information
Pour plus d'information
Für weitere Informationen
Para más información
詳細については

KNOG.COM.AU

WARRANTY:

2 years on materials and workmanship.